



**REVOLVING BOARD ASSEMBLY INSTRUCTIONS**  
***ANLEITUNGEN ZUM ZUSAMMENBAU DER DREHTAFEL***  
**INSTRUCTIONS D'ASSEMBLAGE D'UN TABLEAU PIVOTANT**  
***INSTRUÇÕES DE MONTAGEM DE QUADRO GIRATÓRIO***



For further information, please visit / contact us on:

Tel: (RSA) 010 140 4900 / Email: [sales@parrot.co.za](mailto:sales@parrot.co.za) / [www.parrot.co.za](http://www.parrot.co.za)

**CAUTION**

- Read the instructions carefully before beginning the assembly procedure.
- It is recommended to have two people assembling the product to avoid damages.

Ensure that all parts are included in the packaging before beginning with assembly:

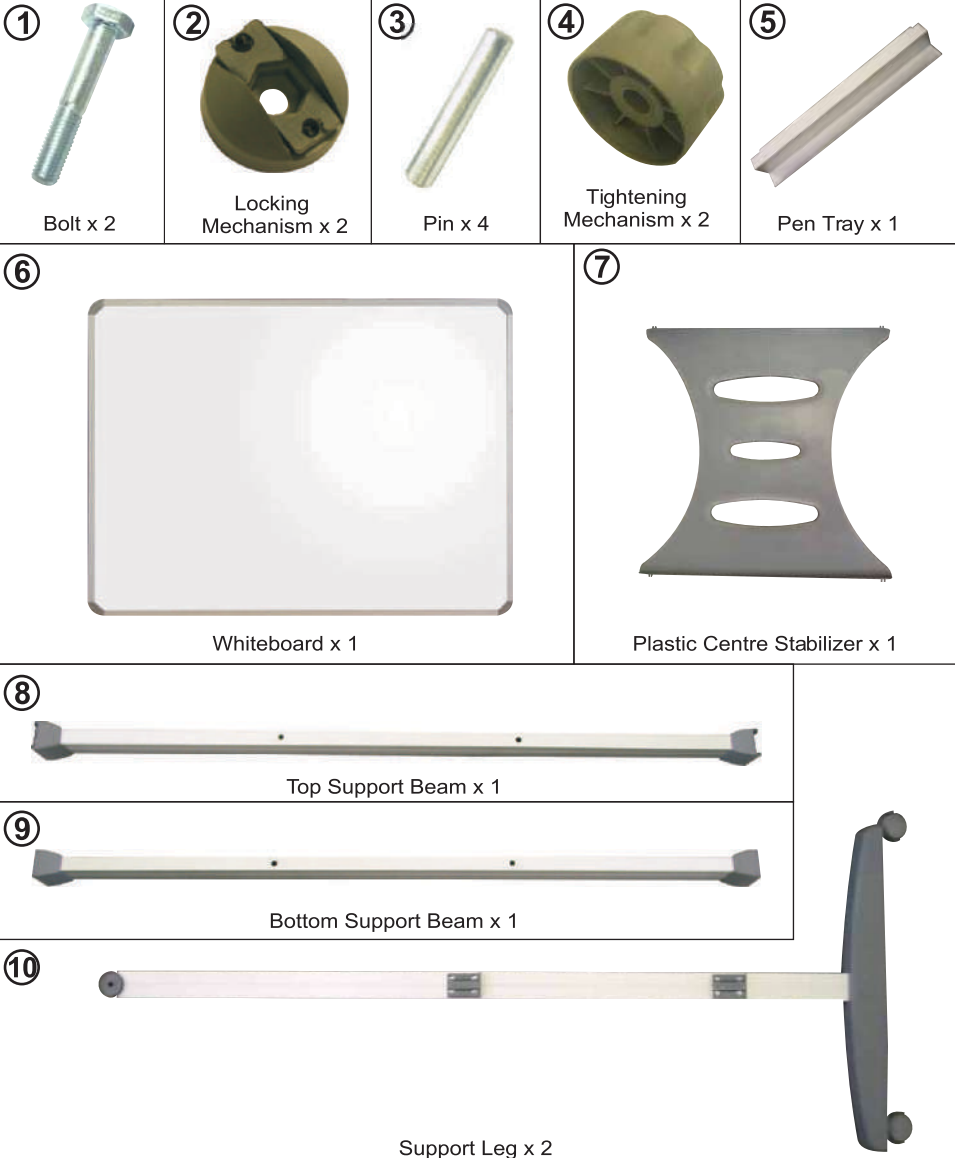

1

Remove Parts ①, ②, ③ & ④ from packaging.

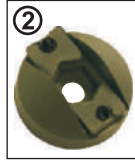

2

Insert Bolt ① into Part ② as shown.

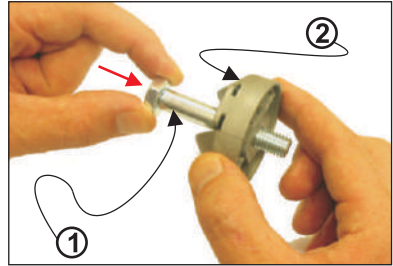

3

Slide part ② into frame of board until the holes ① in part ② correspond with the holes in the frame ②. Push the pins ③ provided into each hole. Apply Step 3 to opposite side of frame.

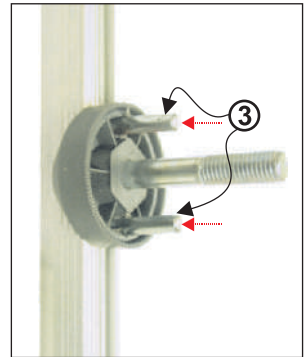
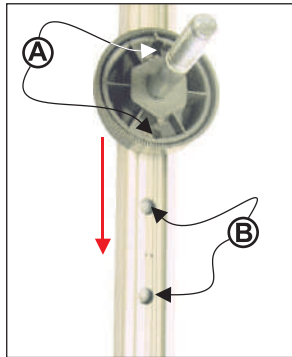
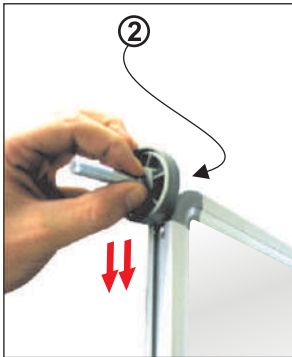

4

Lie board flat on the floor. Place the top of the support leg ⑩ into bolt ① as shown (fig 2). Ensure that the support leg clips are facing inwards ③.

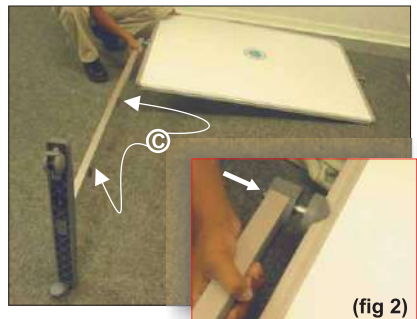

(fig 2)

- 5** Screw part ④ into bolt ① and tighten (fig 3). Repeat step for opposite side.

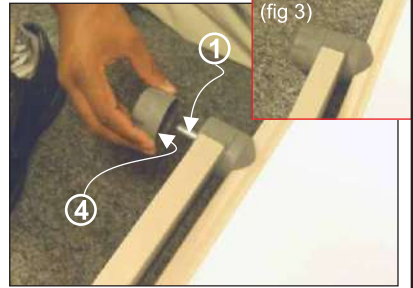

- 6** Slide bottom support beam ⑨ into the clips of the support legs ⑩ in the direction indicated. Slide support beam only half way on the support leg clip (fig 4).

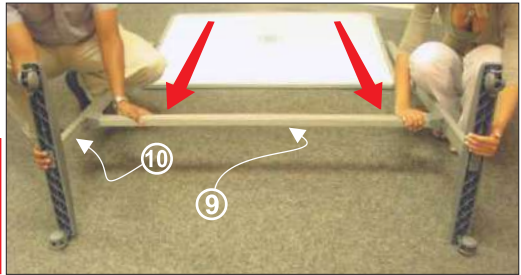
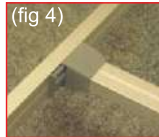

- 7** Lift board into upright position

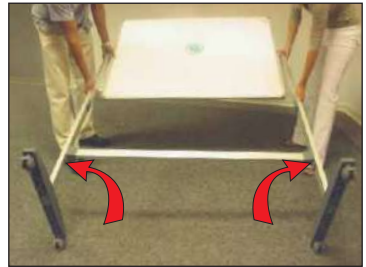

- 8** Push bottom support beam ⑨ down firmly until it clips into position. It is advised that two people are used to press beam down from each side equally.



9

Clip plastic centre panel (7) into holes on bottom support beam (9).

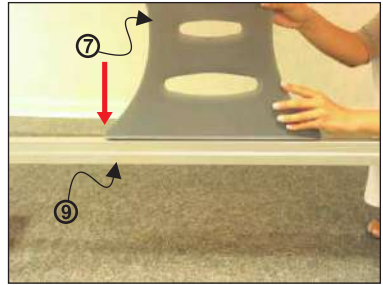

10

Slide top support beam (8) into the top clips between the 2 support legs as shown. Ensure that the holes on the top support beam line up with the plastic centre stabilizer clips (D) (fig 5).

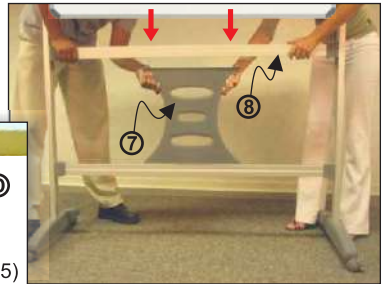
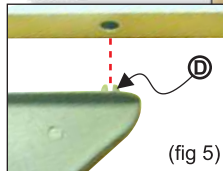

11

It may be necessary to apply some downwards pressure to ensure a secure fit.



12

Place Pen Tray (5) onto the top support beam. Ensure that the tray is in the centre.

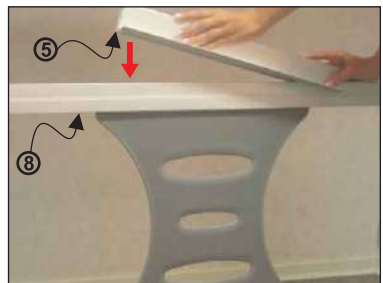

**ACHTUNG**

- Vor dem Zusammenbau bitte die Anleitungen sorgfältig durchlesen
- Der Zusammenbau sollte von zwei Personen unternommen werden, um Schäden vorzubeugen.

Versichern Sie sich, daß die Packung alle Teile enthält, bevor Sie mit dem Zusammenbau anfangen:

①



Bolzen x 2

②



Einrastmechanismus  
x 2

③



Bolzen x 4

④



Festzieh-  
mechanismums  
x 2

⑤



Stiftablage x 1

⑥



Weißwandtafel x 1

⑦



Plastik-Mittelbefestigung x 1

⑧



Oberer Haltebalken x 1

⑨



Unterer Haltebalken x 1

⑩

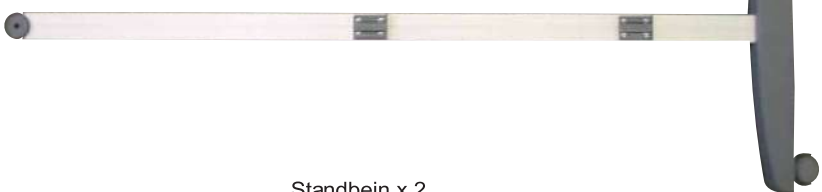

Standbein x 2

1

Nehmen Sie Teile ①, ②, ③ und ④ aus der Packung.

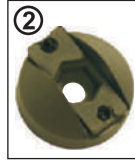

2

Bolzen ① in Teil ② schieben, wie abgebildet.

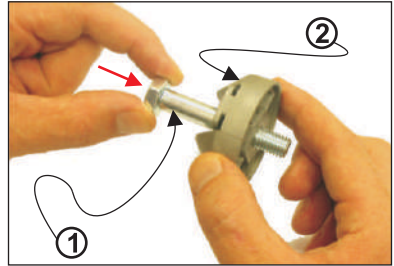

3

Teil ② in den Brettrahmen einschieben bis die Löcher ① in Teil ② mit den Löchern im Rahmen ② übereinstimmen. Die mitgelieferten Bolzen ③ in die Löcher einschieben. Schritt 3 an der entgegengesetzten Seite des Rahmens wiederholen.

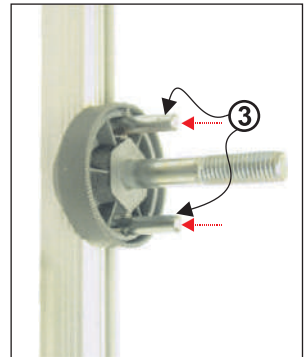
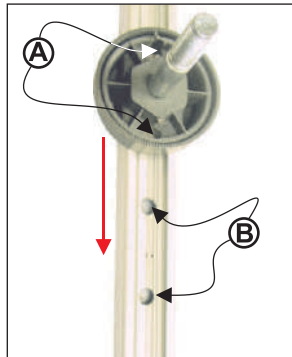
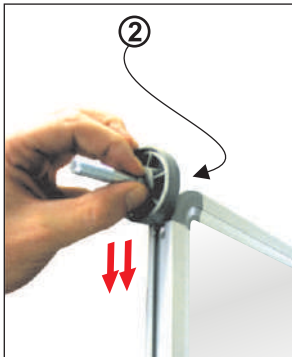

4

Tafel flach auf den Boden legen. Den oberen Teil des Standbeins ⑩ in den Bolzen ① einschieben, wie abgebildet (Abb. 2). Versichern Sie sich, daß die Klammern des Standbeins nach innen zeigen ③.

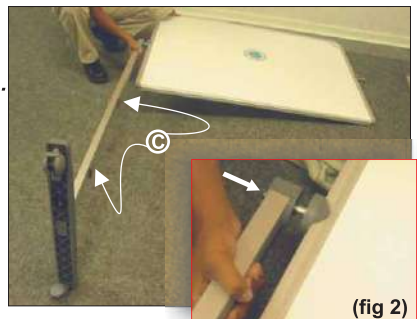

5

Teil ② in Bolzen ① einschrauben und festziehen (Abb. 3). Schritt an der entgegengesetzten Seite wiederholen.

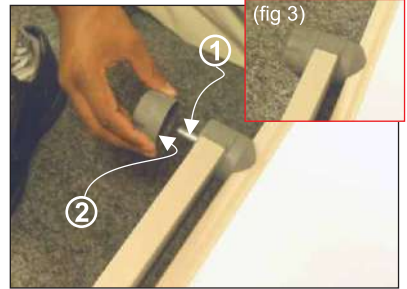

6

Unteren Haltebalken ⑨ in die Klammern der Standbeine ⑩ einschieben (Richtung wie abgebildet). Haltebalken nur bis zur Hälfte der Standbeinklammer schieben (Abb. 4).

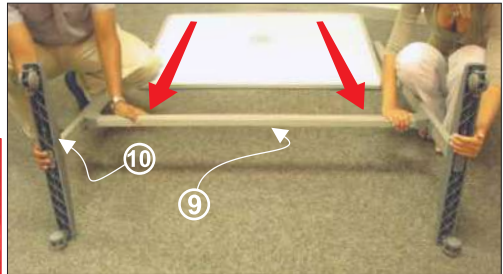

7

Tafel aufstellen.

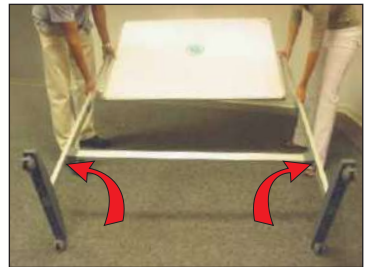

8

Unteren Haltebalken ⑨ fest nach unten drücken, bis er einrastet. Es wird empfohlen, daß zwei Personen, jeder an einer Seite, gleich fest auf den Balken drücken.





9

Plastik-Mittelbefestigung ⑦ in die Löcher im unteren Haltebalken ⑨ einklicken.

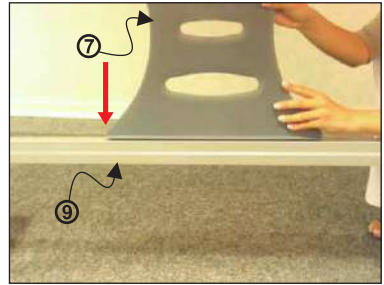

10

Haltebalken ⑧ in die oberen Klammern zwischen den zwei Standbeinen einschieben, wie abgebildet. Versichern Sie sich, daß die Löcher am oberen Haltebalken geradlinig mit den Klammern der Mittelbefestigung ⑦ stehen (Abb. 5).

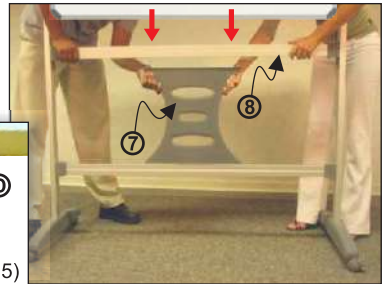
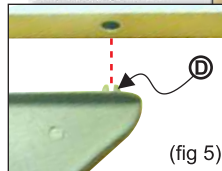

11

Es kann eventuell nötig sein, etwas Druck auf die Haltebalken auszuüben.



12



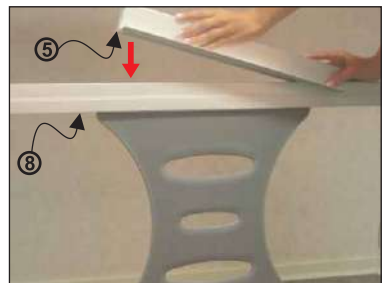

Stiftablage ⑤ mittig auf den oberen Haltebalken legen.



**PRECAUTIONS**

- Lire attentivement les instructions avant de commencer la procédure d'assemblage
- Il est recommandé d'avoir deux personnes pour l'assemblage du produit afin d'éviter les dommages.

S'assurer que toutes les pièces sont incluses dans l'emballage avant de commencer l'assemblage:

<p>①</p>  <p>Ecroux x 2</p>	<p>②</p>  <p>Mécanisme de fermeture x 2</p>	<p>③</p>  <p>Goupille x 4</p>	<p>④</p>  <p>Mécanisme de serrage x 2</p>	<p>⑤</p>  <p>Plateau à marqueur x 1</p>
--	--	--	--	---

⑥



Tableau blanc x 1

⑦



Stabilisateur de centre plastique x 1

⑧



Poutre supérieure de soutien x 1

⑨



Poutre inférieure de soutien x 1

⑩



Pieds de support x 2

1

Retirer de l'emballage les parties ①, ②, ③ & ④.

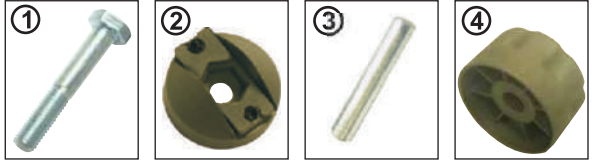

2

Insérer l'écrou ① dans la partie ② comme il l'est montré.

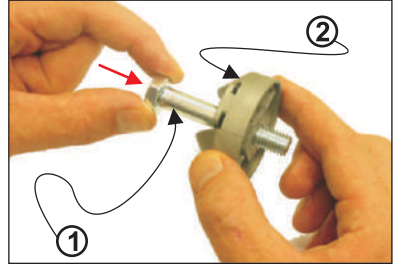

3

Faire glisser la partie ② dans le cadre du tableau jusqu'à ce que les trous A dans la partie ② correspondent aux trous dans le cadre B. Enfoncer les goupilles ③ fournies dans chaque trou. Appliquer l'Étape 3 à l'autre côté du cadre.

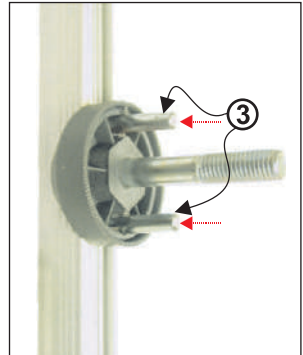
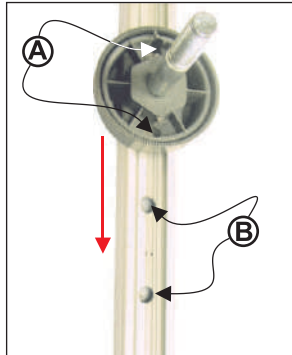
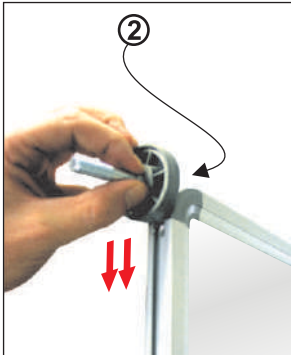

4

Poser le tableau à plat sur le sol. Placer la partie supérieure du pied de support ⑩ dans l'écrou ① comme il est montré (fig. 2). S'assurer que les pieds de soutien font face en direction de C.

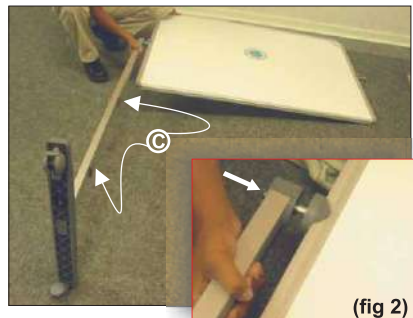

(fig 2)

5

Visser la partie ② dans l'écrou ① et serrer (fig. 3). Répéter cette étape pour le côté opposé.

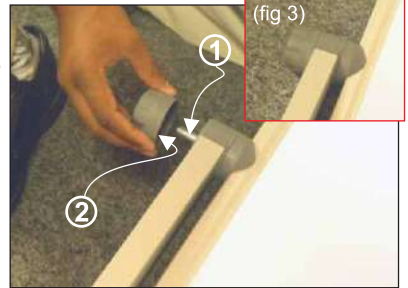

6

Glisser la poutre inférieure de soutien ⑨ dans les clips des pieds de support ⑩ dans la direction indiquée. Glisser la poutre de soutien seulement à moitié sur le clip du pied de soutien (fig. 4).

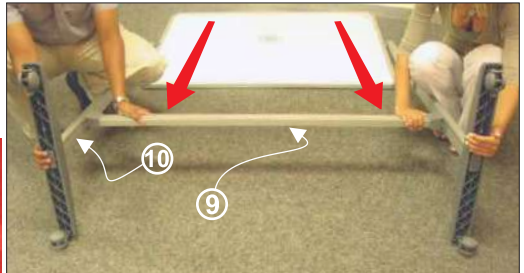
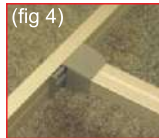

7

Soulever le tableau en position verticale

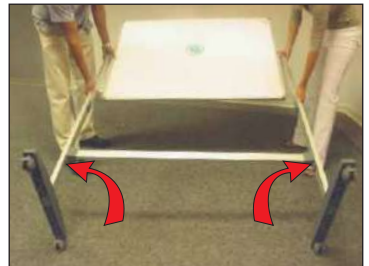

8

Pousser la poutre de soutien ⑨ fermement vers le bas jusqu'à ce qu'elle s'attache dans cette position. Il est conseillé que deux personnes soient habituées à presser la poutre vers le bas également de chaque côté



**9**

Attacher le panneau central en plastique ⑦ dans les trous situés dans la partie inférieure de la poutre de soutien ⑨.

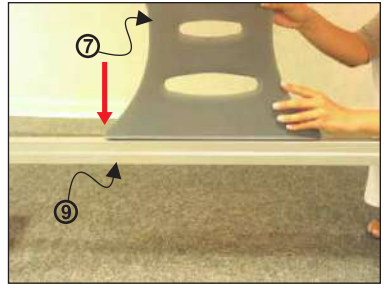

**10**

Faire glisser la partie supérieure de la poutre de soutien ⑧ dans les clips supérieurs entre les 2 pieds de soutien comme il est montré. S'assurer que les trous dans la partie supérieure de la poutre de soutien s'alignent avec les clips ④ du stabilisateur central en plastique (fig. 5).

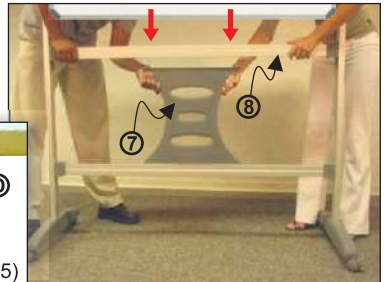
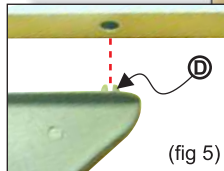

**11**

Il sera peut-être nécessaire de faire pression vers le bas pour assurer que l'assemblage convient.



**12**



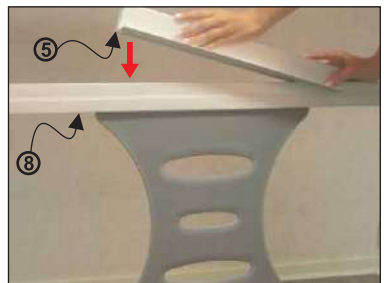

Placer le plateau marqueur ⑤ sur la partie supérieure de la poutre de soutien. S'assurer que le plateau est au centre.



**CUIDADO**

- *Leia as instruções cuidadosamente antes de começar o procedimento de montagem.*
- *É recomendável que duas pessoas façam a montagem juntas para evitar danos.*

*Se assegure de que todas as peças estejam incluídas na embalagem antes de começar a montagem:*

<p>①</p>  <p>Parafuso x 2</p>	<p>②</p>  <p>Mecanismo de Travamento x 2</p>	<p>③</p>  <p>Pino x 4</p>	<p>④</p>  <p>Mecanismo de Apertar x 2</p>	<p>⑤</p>  <p>Bandeja de canetas x 1</p>
--	---	--	--	---

⑥



Quadro Branco x 1

⑦



Estabilizador Central de Plástico x 1

⑧



Trave de Apoio Superior x 1

⑨



Trave de Apoio Inferior x 1

⑩



Perna de Apoio x 2

1

Retire as Peças ①, ②, ③ e ④ da embalagem.

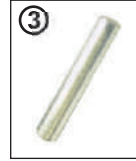
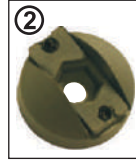

2

Coloque o Parafuso ① na Peça ② como demonstrado.

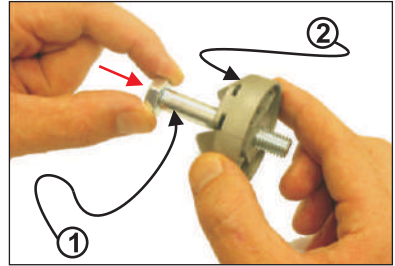

3

Deslize a peça ② na armação da estrutura do quadro até que os orifícios (A) na peça ② correspondam com os orifícios. Na armação (B). Puxe os pinos ③ fornecidos para cada orifício. Aplique o Passo 3 no lado oposto da armação.

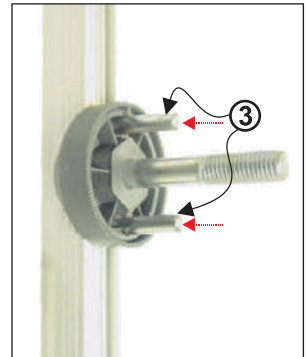
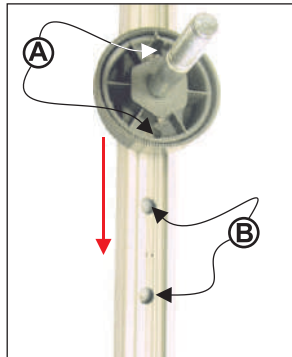
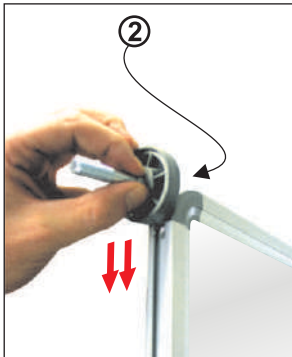

4

Coloque o quadro estendido no chão. Coloque a parte superior na perna de apoio ⑩ para dentro do parafuso ① conforme demonstrado (figura 2). Se assegure que os prendedores da perna estejam voltados para dentro de (C).

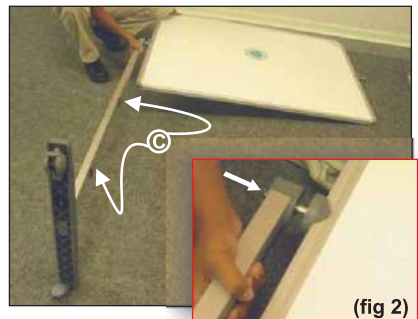

(fig 2)



5

Gire a peça ④ para dentro do parafuso ① e aperte (figura 3). Repita o passo para o lado oposto.

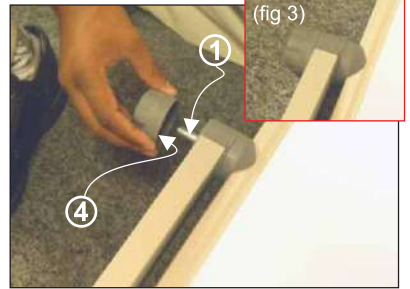

6

Deslize a trave ⑨ de apoio inferior para dentro dos prendedores das pernas de apoio ⑩ na direção indicada. Deslize a trava de apoio somente até a metade do curso no prendedor da perna de apoio (figura 4).

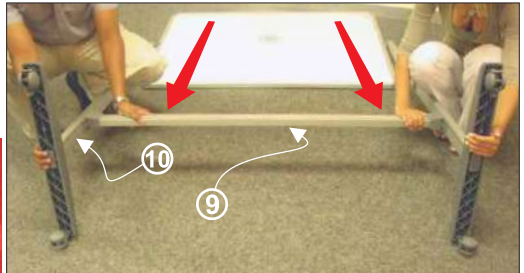

7

Levante o quadro na posição vertical.

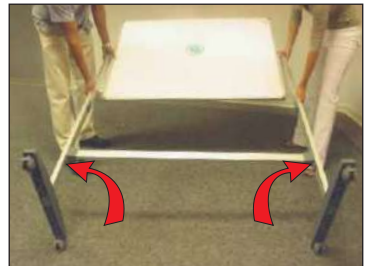

8

Empurre a trave ⑨ de apoio inferior para baixo até que a mesma se encaixe na posição. É aconselhável que sejam usadas duas pessoas para apertar a trave para baixo em ambos lados por igual.





9

Encaixe o painel ⑦ central de plástico para dentro dos furos na trave ⑨ de apoio inferior.

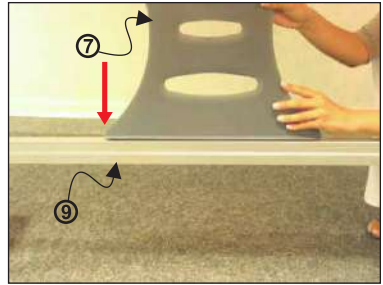

10

Deslize a trave ⑧ de apoio superior para dentro dos prendedores de cima entre as 2 pernas de apoio como demonstrado. Se assegure que os furos na trave de apoio superior estejam alinhados com os prendedores ④ do estabilizador central de plástico (figura 5).

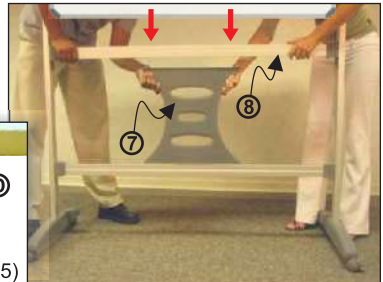
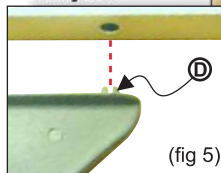

11

Poderá ser necessário aplicar alguma pressão para baixo para garantir um encaixe firme.



12

Coloque a bandeja de canetas na trave de apoio superior. Se assegure que a bandeja esteja no centro.

