

Lucky[®]

LIFESTYLE



WET & DRY TRIPLE HEAD SHAVER

complies with
INTERNATIONAL
IEC60335
SAFETY SPECIFICATIONS



3W

1YEAR
WARRANTY

Model:
MSH3HRWA

PLEASE READ ALL INSTRUCTIONS BEFORE USE



Dear customer,

Thank you for choosing to purchase a Lucky brand product. Thanks to its technology, design and operation and the fact that it exceeds the strictest quality standards, a fully satisfactory use and long product life can be assured.

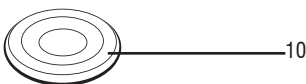
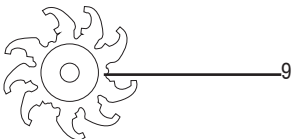
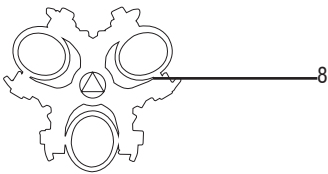
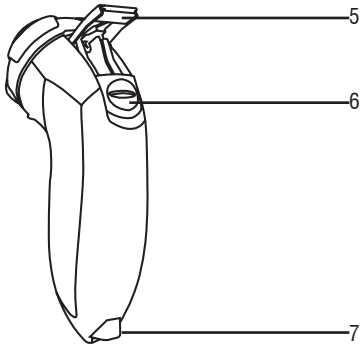
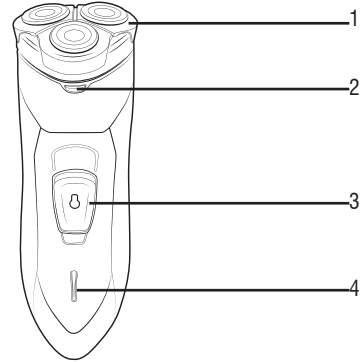

1. Parts description

- 1- Shaving head
- 2- Shaving head release button
- 3- ON/OFF switch
- 4- Charging light
- 5- Pop up trimmer
- 6- Pop up trimmer slide
- 7- Charging input

Internal parts description

8. Blade holder
9. Blade
10. Blade cover

2. Safety advice and warnings!

Read these instructions carefully before switching on the appliance and keep them for future reference. Failure to follow and observe these instructions could lead to an accident. Clean all the parts of the product that will be in contact with face, as indicated in the cleaning section, before use.

2.1. Use or working environment:

- 2.1.1. Keep the working area clean and well lit. Cluttered and dark areas invite accidents.
- 2.1.2. Use the appliance in a well ventilated area.
- 2.1.3. Do not place the appliance on hot surfaces, such as cooking plates, gas burners, ovens or similar items.
- 2.1.4. Keep children and bystanders away when using this appliance.
- 2.1.5. Place the appliance on a horizontal, flat, stable surface away from other heat sources.
- 2.1.6. Do not use the appliance in association with a programmer, timer or other device that automatically switches it on.
- 2.1.7. Do not use the appliance if the cable or plug is damaged.
- 2.1.8. Ensure that the voltage indicated on the rating label matches the mains power supply voltage before plugging in the appliance.
- 2.1.9. Connect the appliance to the mains power supply with an earth socket withstanding a minimum of 10 amperes.
- 2.1.10. The appliance's plug must fit into the mains power supply socket properly. Do not alter the plug.
- 2.1.11. If using a multi plug check ratings carefully as the current used by several appliances could easily

exceed the rating of the multi plug.

2.1.12. If any of the appliance casings breaks, immediately disconnect the appliance from the mains power supply to prevent the possibility of an electric shock.

2.1.13. Do not use the appliance if it has fallen on the floor or if there are visible signs of damage.

2.1.14. Do not force the power cord. Never use the power cord to lift up, carry or unplug the appliance.

2.1.15. Do not wrap the power cord around the appliance.

2.1.16. Do not clip or crease the power cord.

2.1.17. Do not allow the power cord to hang or to come into contact with the surfaces.

2.1.18. Check the state of the power cord. Damaged or tangled cables increase the risk of electric shock.

2.1.19. Power cord should be regularly examined for signs of damage, and if the cord is damaged, the appliance must not be used.

2.1.20. Do not touch the plug with wet hands.

2.2. Personal safety:

2.2.1. CAUTION: Do not leave the appliance unattended during use as there is a risk of an accident.

2.2.2. This appliance is only for domestic use, not for industrial or professional use. It is not intended to be used by guests in hospitality environments such as bed and breakfast, hotels, motels, and other types of residential environments, even in farm houses, offices and other work environments.

2.2.3. This appliance is not intended for use by persons (including children) with reduced physical, sensory or mental capabilities, or lack of experience and knowledge, unless they have been given supervision or instruction concerning use of the appliance by a person responsible for their safety.

2.2.4. This appliance is not a toy. Children should be supervised to ensure that they do not play with the appliance.

2.3. Use and care:

2.3.1. Fully unroll the appliance's power cable before each use.

2.3.2. Do not use the appliance if the parts or accessories are not properly fitted.

2.3.3. Unplug the appliance from the mains power supply when not in use and before undertaking any cleaning task.

2.3.4. This appliance should be stored out of reach of children.

2.3.5. Do not store the appliance if it is still on/hot.

2.3.6. Never leave the appliance unattended when in use and keep out of the reach of children.

2.3.7. If, for some reason, the appliance were to catch fire, disconnect the appliance from the mains power supply and DO NOT USE WATER TO PUT THE FIRE OUT.

2.4. Service:

2.4.1. Make sure that the appliance is serviced only by suitably qualified technician, and that only original spare parts or accessories are used to replace existing parts/accessories.

2.4.2. If the power cord is damaged, the manufacturer or its service agent or a similarly qualified person must replace it in order to avoid a hazard.

2.4.3. Any misuse or failure to follow the instructions for use renders the guarantee and the manufacturer's liability null and void.

3. Instructions for use

3.1. Before use:

3.1.1. Remove the appliance's protective film (if applicable).

3.1.2. Before using the product for the first time, clean the parts that will come into contact with face in the manner described in the cleaning section.

3.1.3. Fully charge the shaver before the first use. It takes about 8 hours to charge the shaver fully.

3.2. Use and care:

Note: Initial use of the Shaver may involve an adjustment period for your face as it gets used to an electric shaver. If changing from manual shaving this may be more noticeable as the technique and cutting style is different. Allow 2-4 weeks to adjust to this method.

Shaving Tips:

- Always shave with a dry face prior to showering or bathing.

- Hold the shaver at a 90° angle to your face to ensure the three heads have equal contact.

- Stretch the skin when shaving to provide a consistent surface to ensure the hairs enter the cutting tracks.

- Avoid pressing the shaver hard against your skin to prevent irritation and potential damage to rotary heads.

- Use a slow circular motion whilst shaving.

- You can use the shaver while it's plugged into a power outlet, however this is not recommended as it may

affect the battery performance over time.

3.2.1. Operating the shaver

- 3.2.1.1. Remove the protective cap.
- 3.2.1.2. Turn the shaver on by pressing the ON/OFF button.
- 3.2.1.3. With the shaver at a 90° angle to your face, stretch the skin and using a circular motion proceed to shave the desired area.
- 3.2.1.4. Press the ON/OFF button to turn the shaver off when finished.

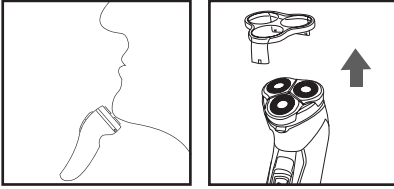

3.2.2. Operating the trimmer

- 3.2.2.1. Remove the protective cap.
- 3.2.2.2. Turn the shaver on by pressing the ON/OFF button.
- 3.2.2.3. Push the trimmer slide towards the head to pop up the trimmer.
- 3.2.2.4. With the trimmer at a 90° angle to your face, stretch the skin and gently shave the desired area.
- 3.2.2.5. Slide the trimmer back down when finished.
- 3.2.2.6. Press the ON/OFF button to turn the shaver off.

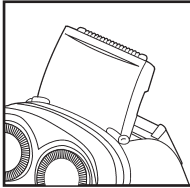

3.3. Charging

- 3.3.1. The shaver can be connected to mains 230 voltages 50HZ.
- 3.3.2. It takes about 8 hours to charge the shaver completely.
- 3.3.3. Fully charged, the shaver will give a maximum of 40 minutes of cordless shaving time.
- 3.3.4. After charging, set the socket wiring aside.

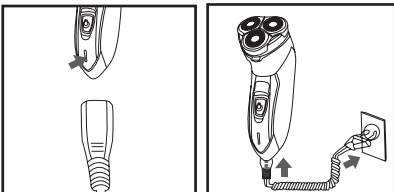

3.4 Once you have finished using the appliance:

- 3.4.1. Allow appliance to cool down.
- 3.4.2. Unplug the appliance from the mains power supply.
- 3.4.3. Clean the appliance as described in the cleaning section.

4. Cleaning and maintenance:

Regular cleaning of the shaver is very important to continue optimal performance of the appliance. Take care when cleaning the internal parts of the shaver, they have been precision made and any rough handling could easily result in damage and affect performance. Ensure before performing any cleaning the shaver is turned off and unplugged from any power point.

4.1 Daily cleaning

- 4.1.1. Ensure the unit is turned off and is unplugged from any power point.
- 4.1.2. Press the shaving head release button.
- 4.1.3. Shake out any hairs. Use the included cleaning brush to remove any stubborn hairs.

NOTE: Be careful not to shake too vigorously. Do not bend the shaving head backwards as this may damage the hinge.

4.2. Cleaning the trimmer

- 4.2.1. Ensure the unit is switched off and is unplugged from any power point.
- 4.2.2. Push the trimmer slide towards the head to pop up the trimmer.
- 4.2.3. Use the included brush to remove any hairs from the blades.

4.3. Monthly cleaning

Perform a more thorough cleaning of the shaving head components every month to ensure these delicate parts continue to operate as expected.

- 4.3.1. Ensure the unit is turned off and is unplugged from any power point.
- 4.3.2. Press the shaving head release button.
- 4.3.3. Shake out any hairs.
- 4.3.4. Turn blade holder anti-clockwise to remove blades from blade covers.

4.3.5. Gently pull out the blade covers and blades from the front face. Separate the blades from the blade covers.

4.3.6. Use the included brush to thoroughly clean the blade covers and blades.

4.3.7. Remove the blade head by gently pulling it away from the shaver.

4.3.8. Wash the blade covers, blade head and blades with a small amount of soap and water then rinse.

4.3.9. Allow to dry before reassembling.

4.3.10. With the shaving head still open, place the blade covers back into the slots.

NOTE: Do not force parts back into place as the shaving head may snap backwards causing damage.

4.3.11. Insert the blades into the blade covers.

4.3.12. Ensure the blade holder is inserted correctly and turn clockwise to secure blades in place.

4.3.13. Close the shaving head and replace the protective cap.

NOTE: If you have issues closing the shaving head, check that all parts are assembled correctly.

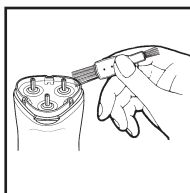
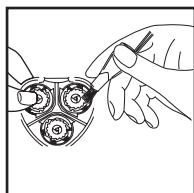
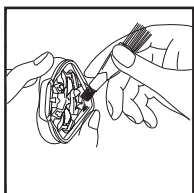
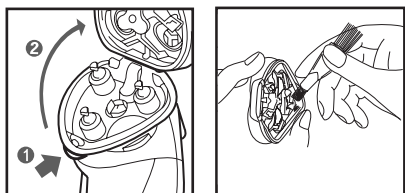

5. Anomalies and repair

5.1. Take the appliance to an authorised support centre if product is damaged or other problems arise.

5.2. If the connection to the mains has been damaged, it must be replaced and you should proceed as you would in the case of damage.



Lucky guarantees that this product has been thoroughly inspected and tested before being dispatched and is free from mechanical and electrical defects and complies with the applicable safety standards. However, should defects due to faulty material or workmanship develop, under normal domestic use, within 6 months from the date of purchase please return the product to the store from where it was purchased for a full refund or replacement.

The following conditions apply:

- 1) Please ensure you retain your receipt as this must be presented when making a claim under the terms of the warranty. It is impossible to determine the warranty period without proof of purchase, so please keep this in a safe place.
- 2) If a refund or exchange is required the product must be complete with all accessories, parts and packaging. Missing parts will render the warranty void.
- 3) Upon receipt of your appliance check it for any transport damage to ensure it is safe for use. Return it to the store as soon as possible for exchange if damaged. The warranty is void if products are damaged after use, so please do not use the damaged product.
- 4) Your product is designed for normal domestic household use. Failure to read and comply with the instructions for use, cleaning and maintenance will render your warranty void, so please read these instructions carefully to ensure your safety, and get the most effective use from the product. (e.g. lime scale; water deposits; and/or insect infestation)
- 5) Any abuse, negligent, improper or accidental use or care will render the warranty void and Creative Housewares (Pty) Ltd will not be liable for any loss or damage.
- 6) Any attempted repair, or replacement of unauthorised parts will render the warranty void, so please contact an authorised service centre or agent for any service or repair requirements.

Extended 12 Month Limited Warranty

Lucky offer an extended 12 month limited warranty from the date of purchase to offer the consumer peace of mind on their purchase. Should defects due to faulty material or workmanship develop, under normal domestic use, within 12 months from the date of purchase, please return the product to the store from where it was purchased for replacement.

Before returning your product, check for the following:

- 1) Your household mains supply socket is working and switched on.
- 2) The mains supply circuit is not overloaded (White trip switch on your DB board is off).
- 3) You have read the trouble shooting guide in your Instructions for Use.
- 4) All accessories and parts are present.

If service or repair becomes necessary outside the warranty period, this service is still available however all transport/postage, spares and labour costs will be paid by the consumer. All chargeable repairs will require the consumers' approval in writing once the quote is accepted. Once the go-ahead has been received Lucky will undertake to conduct the repair within a reasonable time and maintain the condition of the product as received.

All repairs carry a 3 month warranty. Lucky will attempt to conduct repairs within reasonable industry standards but cannot be held responsible or liable for any circumstances not under their direct control.

National Service Centre: 086 111 5006

e-mail: help@creativehousewares.co.za

creative housewares

web: www.creativehousewares.co.za

Cape Town

20 Tekstiel Street, Parow, Cape
Town, 7493, South Africa • P.O. Box
6156 Parow East, 7501, South Africa
Tel: +27 21 931 8117
Fax: +27 21 931 4058

Durban

35 Adrain Road, Windermere,
Durban, South Africa, 4001
Tel: +27 31 303 3465
Fax: +27 31 303 8259

Johannesburg



Unit 25 & 26 San Croy
Officepark, Die Agora Road,
Croydon, 1619
Tel: +27 11 392 5652
Fax: +27 11 392 1694

1 year warranty

creative housewares

 20 Tekstiel Street, Parow, Cape Town, 7493, South Africa

 P.O. Box 6156 Parow East, 7501, South Africa

 +27 21 931 8117  +27 21 931 4058

Service Centre Helpline: 086 111 5006

 www.creativehousewares.co.za